

# ELECTRO KABUKU (EK2) SYSTEM

EK2 is a smart and exceptionally easy-to-use system, and the selection of parts can be configured to meet your exact event requirements. The EK2 modules create the action at the end of the line. The firing and control boxes are the heart and Brains of the entire system, and along with these basic components, there are many useful parts that make the rigging simple and the whole construction instantly effective.

## EK2 IS EASY TO RIG AND OPERATE:

- » Simply attach the EK2 modules to an horizontal
- » Space them about a foot apart
- » Link together with simple color-coded EK cabling
- » Connect firing box to one end of the circuit
- » Check the status indicators on the EK2 modules
- » Switch the firing box to "Armed" and when you've got your cue, just press the firing button!

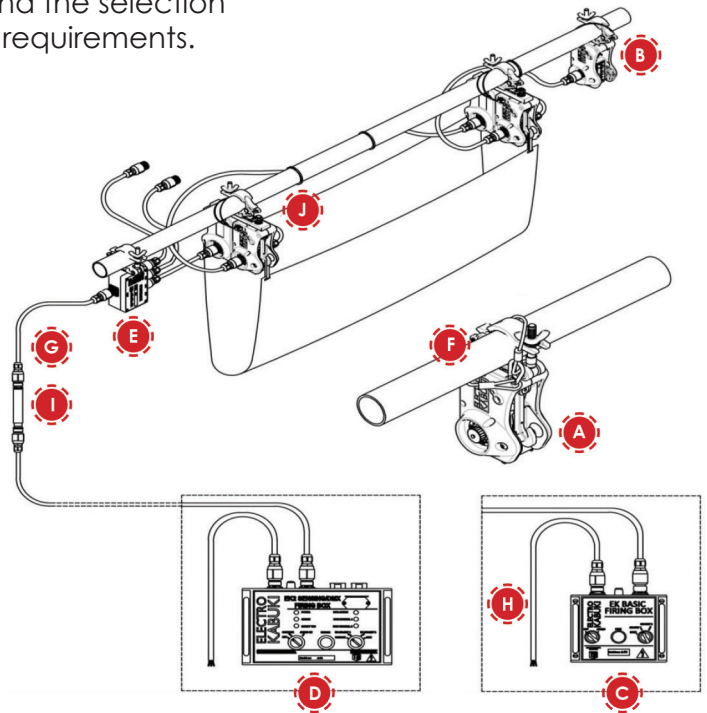

**A: ELECTRO KABUKI**  
Supports the drape or item and releases it when signaled. Available in different voltages – 110V & 230v AC.



**B: END-OF LINE INDICATOR**  
Part of the circuitry that proves electrical continuity in the cabling. Only used with the DMX/ Sensing Firing Box.



**C: BASIC FIRING BOX**  
Houses a push-button for local firing of the EKs and controls which EKs are fired.



**D: SENSING/DMX FIRING BOX**  
Houses a push-button for local firing of the EKs and controls which EKs are fired.



**E: SPLITTER BOX**  
Divides the power cable into 3 branches. Helps simplify system layout and reduce amount of cable needed.



**F: CLAMP**  
Heavy duty truss clamp that attaches the EK to a supporting truss or rail.



**G: LINK CABLE**  
Connects one item in the system to another. Available in different lengths.



**H: POWER CABLE**  
Connects the power supply to the Firing Box. Fitted with a connector at one end and bare wires at the other.



**I: IN-LINE COUPLER**  
Connects 2 link cables to form a longer continuous length.



**J: BACK-TO-BACK BRACKET**  
Supports 2 EKs on 1 clamp (for "flop and drop" releases).